

CTM 26 E
CTM 26 E AC
CTM 36 E
CTM 36 E AC
CTM 36 E AC-LHS
CTM 36 E AC-RENOFIX

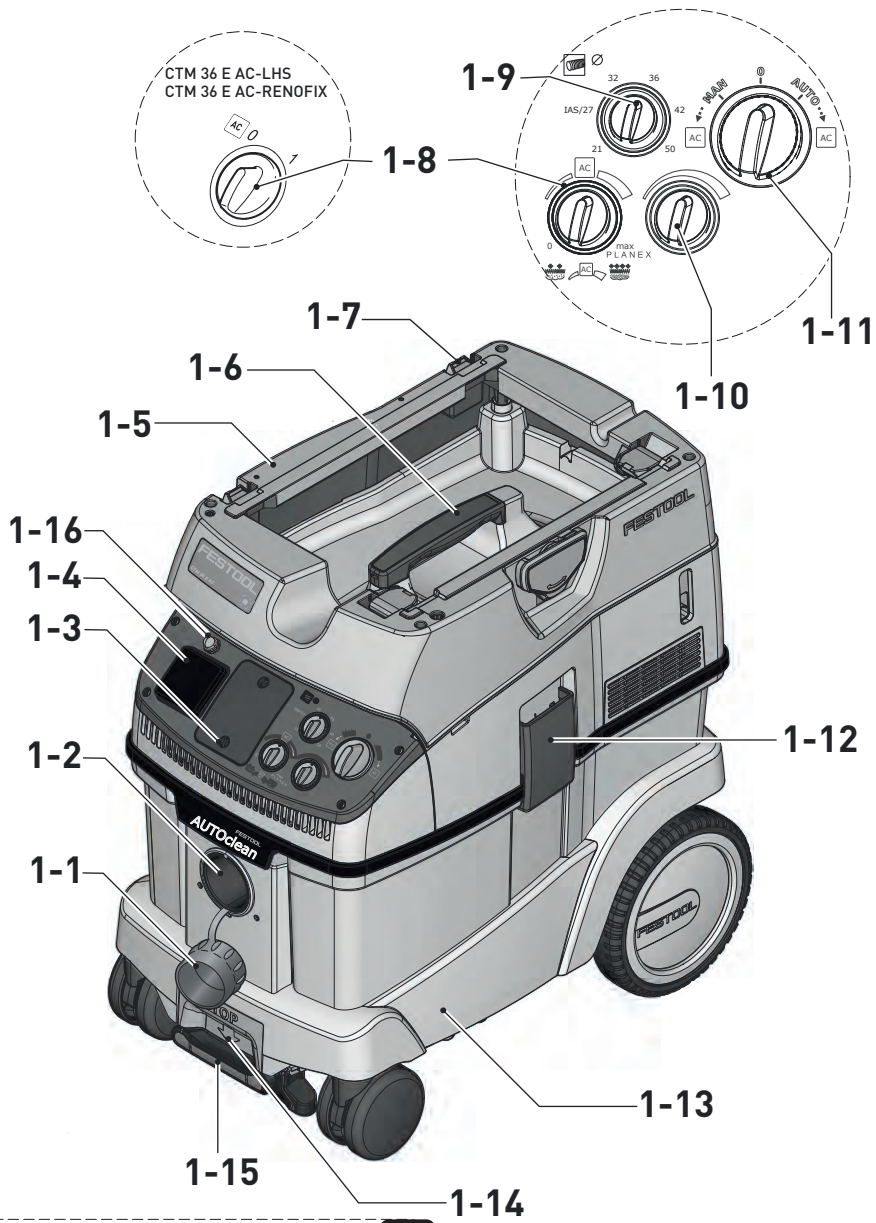

1



PLANEX LHS 2 225

1A

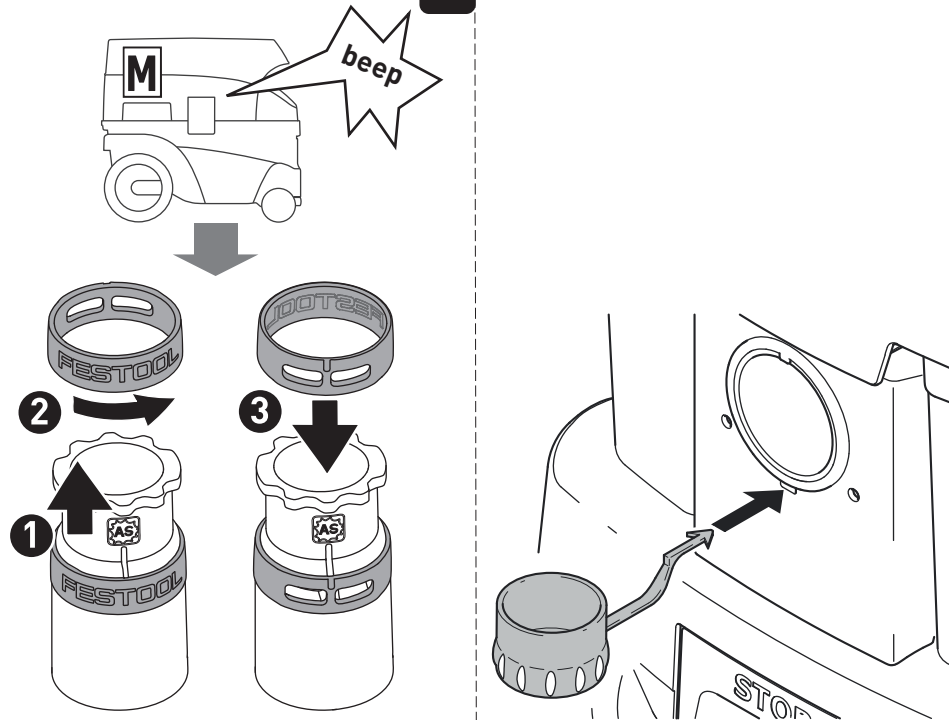

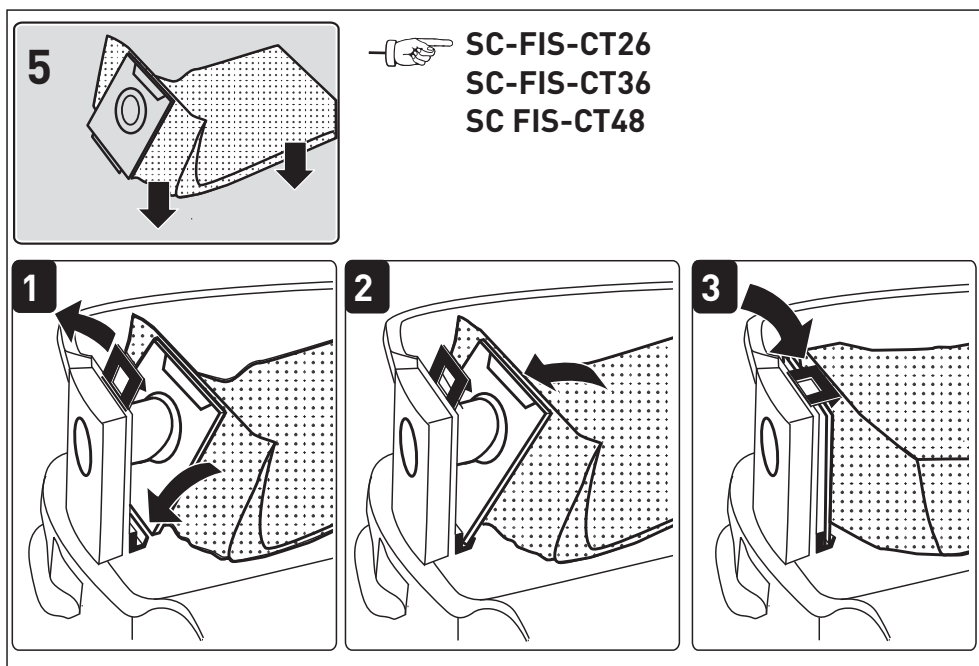
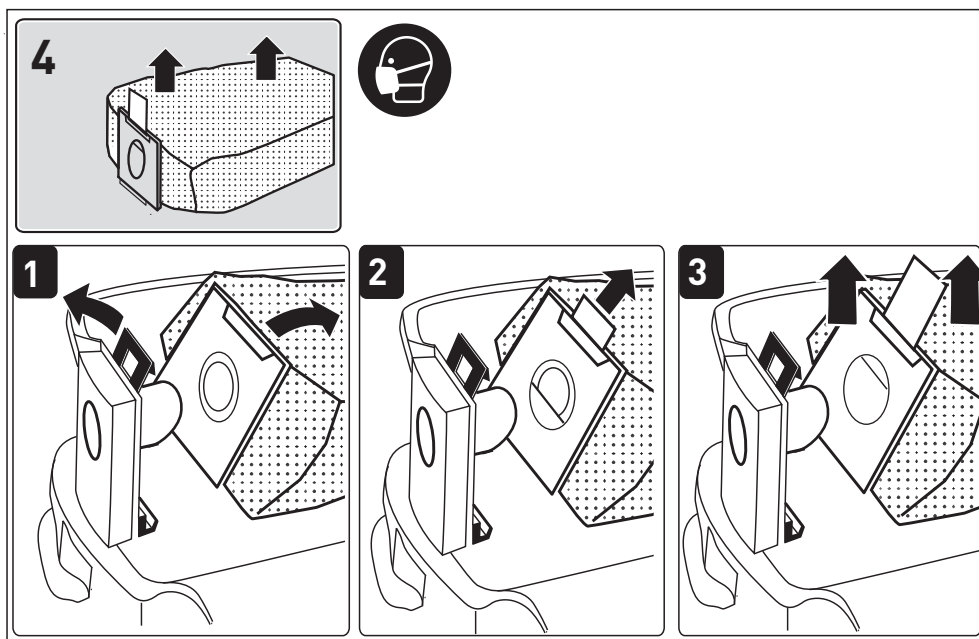
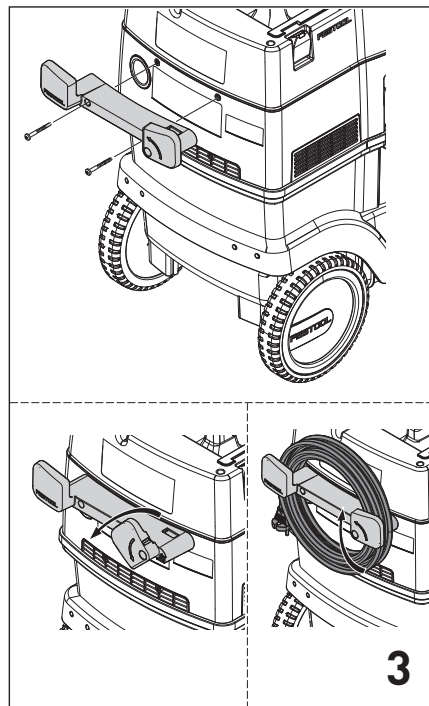
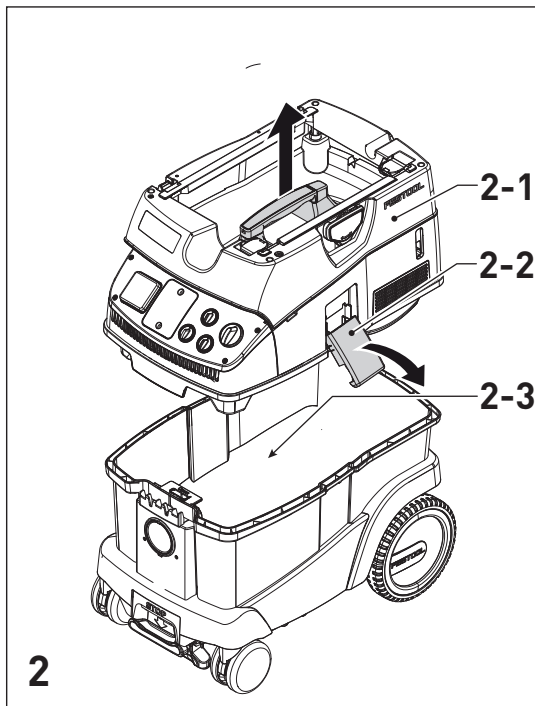

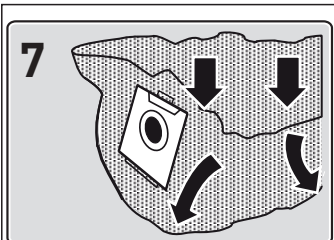
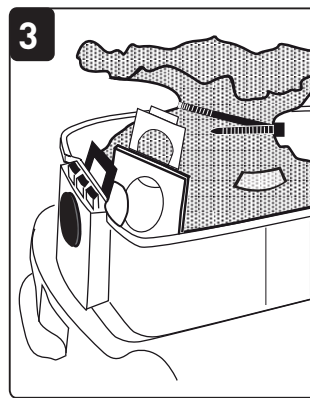
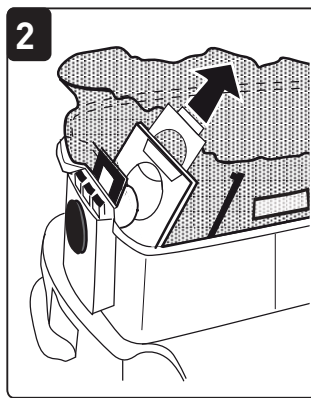
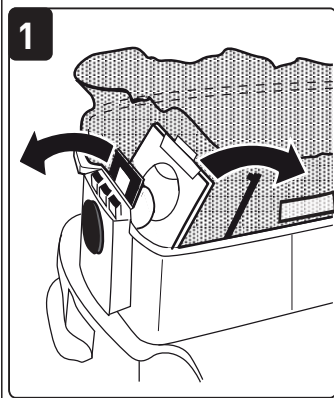

ENS-CT26
ENS-CT36
ENS-CT48

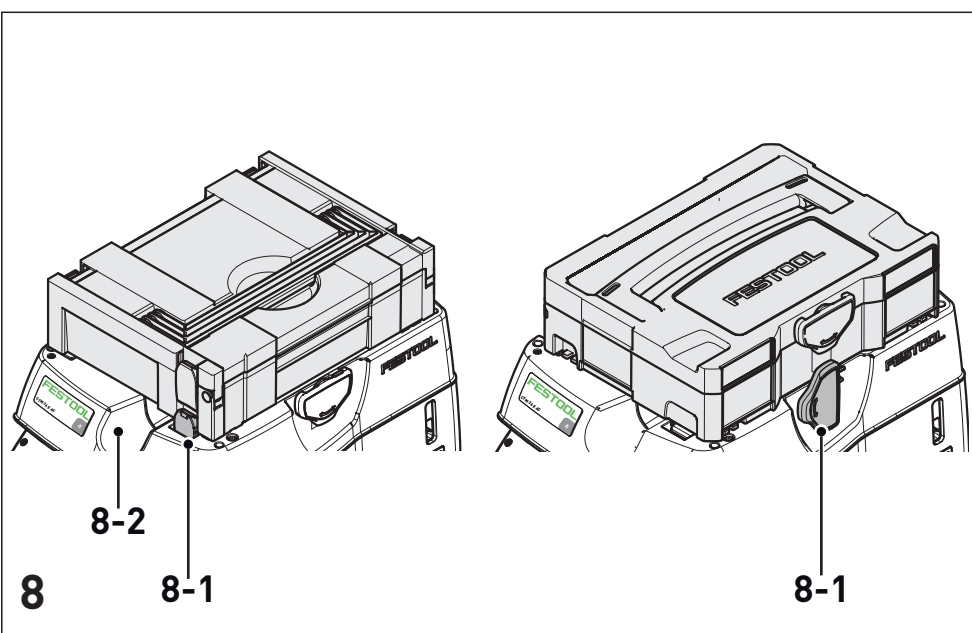
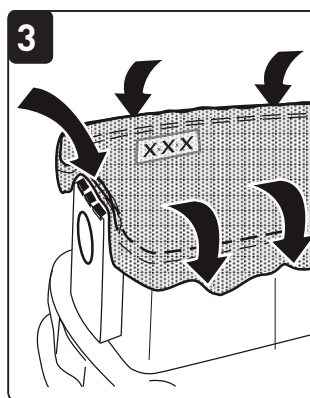
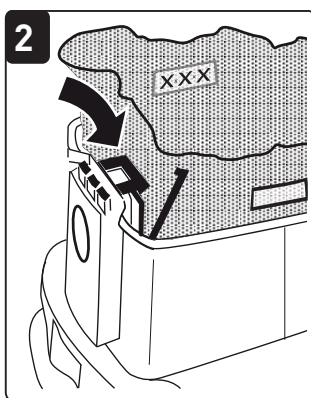
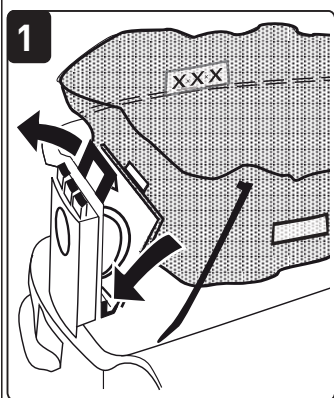
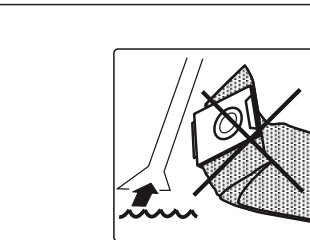



9-1

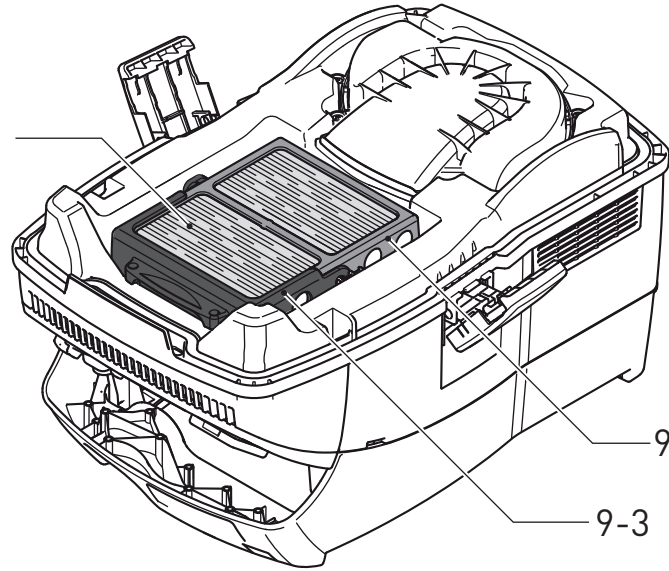

9-2

9-3

9

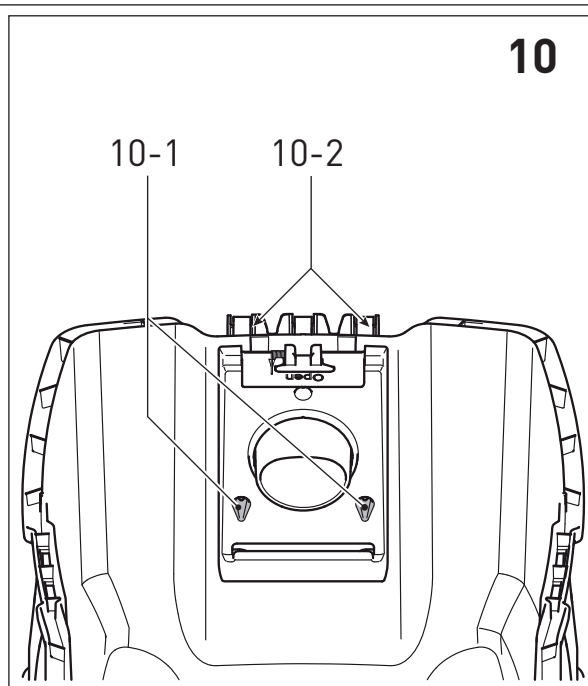
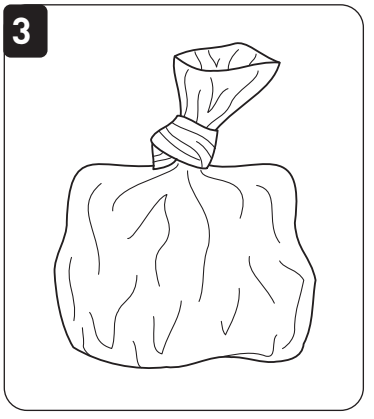
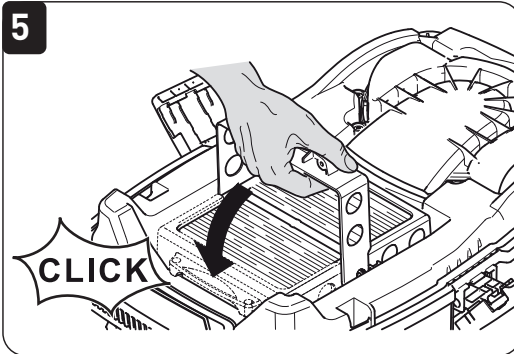
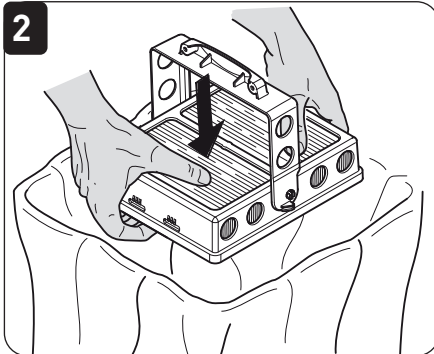
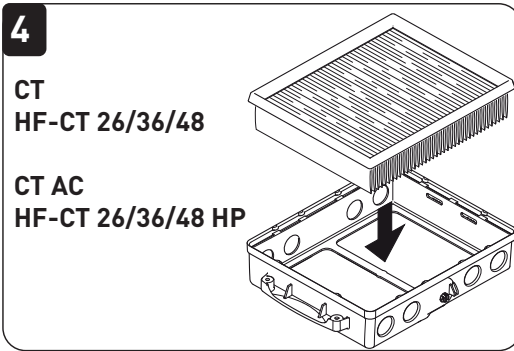
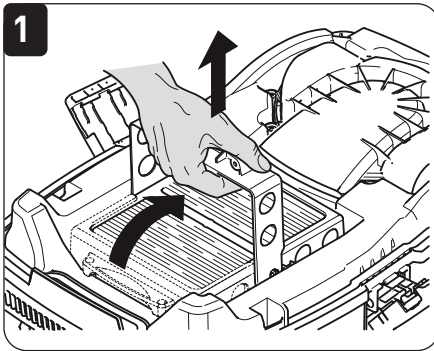

Contents		
1 Safety warnings.....	6	6 Commissioning..... 8
2 Symbols.....	7	7 Settings..... 9
3 Machine features.....	7	8 Working..... 10
4 Technical data.....	8	9 Service and maintenance..... 11
5 Intended use.....	8	10 Accessories..... 12
		11 Environment..... 12

1 Safety warnings



WARNING! Read all safety warnings, instructions, illustrations and specifications provided with this power tool. Failure to follow all instructions listed below may result in electric shock, fire and/or serious injury.

Save all warnings and instructions for future reference.

- This machine must not be used by persons (including children) with reduced physical, sensory or mental capabilities, or lack of experience and knowledge. **Children** need to be supervised to ensure they do not play with the machine.



- **WARNING!** The machine may contain hazardous dust. Only have the machine maintained and emptied, and only have the filter replaced by an authorised specialist using suitable protective equipment.
- Always operate with the filter system installed.
- Always use suitable protective equipment.
- If intact following a visual inspection, work in a dry environment according to instructions.

WARNING! When extracting dust that exceeds the limit value or large volumes of oak or beechwood dust, only extract from one dust source (power or compressed-air tool).

– **Risk of explosion and fire! Do not extract:**

- Sparks, glowing parts or hot dust;
- Combustible or explosive materials (e.g. magnesium, aluminium, petrol, diluting agents – with the exception of wood);
- Aggressive materials (e.g. acid, alkaline solutions, solvents);
- Chemically reactive materials, which lead to the generation of heat, acids/bases, gases, etc. (e.g. reactive two-component materials, aluminium and water).
- Observe all national safety regulations as well as the material manufacturer's specifications.
- Only use the electrical outlet module on the machine for its stated purpose.



- Check the plug and the cable regularly in order to prevent a hazard. In the event of damage, these must be replaced by an authorised service workshop only.
- Do not lift or transport the machine using a crane hook or lifting gear.
- This machine must not be used by people who might have a particularly adverse reaction to an electric shock (e.g. **people with cardiac pacemakers**), because the possibility of the machine building up a static charge cannot be excluded.
- Use only the original Festool suction hose.
- **Pay attention to the work environment and watch out for your own safety and the safety of others when transporting or working with the machine.**

In this way, you can for example prevent tripping hazards caused by the suction hose or mains cable.

- **Keep packaging film away from children.**
There is a risk of suffocation.

2 Symbols

Symbol Significance



Warning of general danger



Risk of electric shock



Read operating instructions and safety notices!



Wear a dust mask.



Tip or advice



Handling instruction



Warning! The machine may contain hazardous dust!



Do not dispose of as domestic waste.

[1-3] Module slot (compressed air module for CTM 36 E LE, CTM 36 E LE AC, CTM 48 E LE, CTM 48 E LE AC)

[1-4] Appliance socket

[1-5] Hose store

[1-6] Handle

[1-7] SysDoc

[1-8] Automatic cleaning (only versions with AutoClean)

[1-9] Hose diameter setting

[1-10] Suction power adjuster

[1-11] Switch

[1-12] Locking clip

[1-13] Dust container

[1-15] Brake

[1-16] Electrical outlet module circuit breaker

3 Machine features

[1-1] Sealing plug

[1-2] Intake opening

The specified illustrations appear at the beginning of the Operating Instructions.

4 Technical data

Mobile dust extractors		
Power consumption		350 - 1200 W
Maximum appliance socket connected load		1200 W
Max. suction capacity (air), extractor/turbine		130 m ³ /h / 234 m ³ /h
Max. vacuum, turbine		24000 Pa
Filter surface area		6318 cm ²
Suction hose	CTM 26 E, CTM 36 E, CTM 36 E AC	D 27/32 mm x 3.5 m-AS
	CTM 36 E AC-LHS, CTM 36 E AC-RENOFIX	D 36/32 mm x 3.5 m-AS
	CTM 36 E AC-LHS (with Planex Sander)	D 36 mm x 3.5 m-AS/KS/LHS 225
Length of the net cable		7.5 m
Sound pressure level as per EN 60704-2-1 / Uncertainty K		71 dB(A) / 3 dB
Protection category		IP X4
Container capacity	CTM 26 E	26 l
	CTM 36 E, CTM 36 E AC, CTM 36 E AC-LHS, CTM 36 E AC-RENOFIX	36 l
Dimensions L x W x H	CTM 26 E	630 x 365 x 540 mm
	CTM 36 E, CTM 36 E AC, CTM 36 E AC-LHS, CTM 36 E AC-RENOFIX	630 x 365 x 596 mm
Weight	CTM 26 E	13.9 kg
	CTM 36 E	14.4 kg
	CTM 36 E AC, CTM 36 E AC-LHS, CTM 36 E AC-RENOFIX	15.2 kg

5 Intended use

Mobile dust extractor suitable for

- Extracting dust up to 0,1 mg/m³ according to dust class 'M', including wood and paint dust,
- Extracting water,
- Increased loads during commercial use, according to IEC/EN 60335-2-69.



The user is liable for improper or non-intended use.

6 Commissioning



WARNING

Unauthorised voltage or frequency!

Risk of accidents

- ▶ Observe the specifications on the machine's name plate.
- ▶ Observe country-specific regulations.

6.1 Initial operation

- ▶ Open the locking clips **[2-2]** and remove the top section of the machine **[2-1]**.
- ▶ Remove the accessories from the dust container **[2-3]** and the packaging!
- ▶ Insert a filter or disposal bag in the dirt trap (see chapter 7.8 and 7.9).
- ▶ Replace the top section **[2-1]** and close the locking clips **[2-2]**.

- ▶ Attach the cable holder to the rear of the mobile dust extractor (see Fig. [3]).
- ▶ Connect the suction hose to the machine.

6.2 Switching on/off

- ▶ Insert the mains plug into an earthed socket.



WARNING

Risk of injury from tools starting up unexpectedly

- ▶ Before setting the switch to the "AUTO" or "MAN" position, make sure that the connected tool is switched off.

The switch [1-11] serves as an on/off switch.

"0" switch position

Appliance socket [1-4] is disconnected from the power, mobile dust extractor is switched off.

"MAN" switch position

Appliance socket [1-4] is connected to the power, the mobile dust extractor starts.

"Auto" switch position

Appliance socket [1-4] is connected to the power, the mobile dust extractor starts when the connected tool is switched on.

7 Settings

7.1 Adjusting the hose diameter

- ▶ Adjust the hose diameter adjuster [1-9] to match the diameter of the connected hose.

 The monitoring devices will measure the air speed in the extractor hose correctly as a result (see chapter 7.10).

7.2 Connecting electric power tools



WARNING

Risk of injury

- ▶ Observe the maximum electrical outlet module connected load (see section "Technical data").
- ▶ Switch off the power tool.
- ▶ Connect the power tool to the electric outlet module [1-4].

Electrical outlet module circuit breaker

If the maximum connected load at the electrical outlet module of the power tool is exceeded, the circuit breaker separates the electrical outlet module from the voltage supply.

- ▶ Turn off the power tool using the switch.
- ▶ Wait approx. 20 seconds.

- ▶ Activate the circuit breaker [1-16].
- ▶ Turn the power tool back on.

7.3 Connecting pneumatic tools



WARNING

Risk of injury

- ▶ Switch off the air tool.

Automatic on/off switch for air tools (CTM 36 E LE, CTM 36 E LE AC, CTM 48 E LE, CTM 48 E LE AC or accessories)

with compressed air module in module slot [1-3]

Recommendation:

- Attachment of service unit VE (495886): compressed air filtered and lubricated
- Use of IAS system with IAS connector (454757) for Festool air tools

Requirement: tool with operating pressure of 6 bar!

7.4 Adjusting the suction power

- ▶ at the rotary knob [1-10].

7.5 Connecting sleeve

The bypass function of the connecting sleeve prevents strong suction from sanding machines and floor nozzles on smooth surfaces.

Open

- ▶ Turn the adjusting ring to the "OPEN" position.

Close

- ▶ Turn the adjusting ring to the "CLOSE" position.

7.6 Applying the brake

Folding out the black brake lever [1-15] prevents the mobile dust extractor from rolling. To achieve this, lift the front end of the mobile dust extractor slightly and push the black brake lever downwards until it latches into place. Push the green lever [1-14] to release.

7.7 Temperature cut-out

To prevent overheating, a temperature cut-out switches the mobile dust extractor off when it reaches a critical temperature.

- ▶ Switch off the mobile dust extractor and allow to cool for about 5 minutes.

 If the mobile dust extractor will not switch on again, please contact a Festool service workshop.

7.8 Changing the filter bag (SC FIS-CT 26/36/48)

Removing the filter bag [4]

- ▶ Open the locking clips [2-2] and remove the top section of the machine [2-1].
- ▶ Remove the filter bag.
- ▶ Dispose of the used filter bag in accordance with statutory regulations.
- ▶ Clean the dust container [2-3].

Inserting the filter bag [5]

- ▶ Insert a new filter bag (SC FIS-CT 26/36/48) in the inlet port of the dust container and interlock it. **Important:** be aware that the locking engages.
- ▶ Replace the top section [2-1] and close the locking clips [2-2].

 Make sure that the filter bag is not pinched between the top and bottom sections.

7.9 Changing the disposal bag

Removing the disposal bag [6]

- ▶ Close off the extractor opening [1-2] using the sealing plug [1-1].
- ▶ Open the locking clips [2-2] and remove the top section of the machine [2-1].
- ▶ Close the disposal bag.
- ▶ Remove the disposal bag.
- ▶ Dispose of the used disposal bag in accordance with statutory regulations.
- ▶ Clean the dust container [2-3].

Inserting the disposal bag [7]

- ▶ Insert a new disposal bag (ENS-CT26/36/48) on the inlet nozzle of the container and lock in position.

Important: The lateral openings on the disposal bag must be positioned inside the container. Make sure that the bolt engages.

- ▶ Place the disposal bag over the edge of the container.

 Make sure that the contacts [10-2] are free.

- ▶ Replace the top section [2-1] and close the locking clips [2-2].

7.10 Volumetric flow monitoring

An acoustic warning signal sounds if the air speed in the suction hose falls below 20 m/s (at dust class 'M').

Possible causes	Solution
Value set on the suction power adjuster [1-10] is too low.	Set the suction power adjuster to a higher value (see Chapter 7.4).
Rotary knob [1-9] not set to the correct hose diameter.	Set the knob to the correct hose diameter (see Chapter 7.1).
Suction hose blocked or kinked.	Remove blockage or kink.
Filter bag full.	Insert a new filter bag (see Chapter 7.7).
Filter element clogged.	Change the filter element (see Chapter 9.1). Only AUTO Clean : clean filter element (see chapter 8.2).
Monitoring electronics malfunction.	Send to a Festool service workshop for repair.
Wet extraction.	Functional reliability not affected, no actions required.
ONLY CTM 36 E AC-LHS with PLANEX LHS 2 225: In tasks that require a low extraction setting (e.g. on soft surfaces).	Activate bypass function on special extraction sleeve [1A].

8 Working

8.1 Handling

Hose holder: After finishing work, you can feed the suction hose through the opening [8-2] and place it in the hose holder.

SysDoc Systainer storage area: A Systainer can be fastened to the storage area with the four slides or the T-Loc lock [8-1].

8.2 AUTOClean - Cleaning the main filter (only versions with AutoClean)

 **Only in conjunction with disposal bag** (compliance with dust class 'M'). Not suitable for wet extraction!

Automatic cleaning

Adjust the frequency using the rotary knob [1-8].

Only CTM 36 E AC-LHS / CTM 36 E AC-RENOFIX: switch on using the rotary knob [1-8].

Manual cleaning

Turn the switch [1-11] to the **AC** symbol.

Full manual cleaning

- ▶ Cover the end of the nozzle or suction hose with your hand or closing slide CT-VS (497926) for 2 seconds.
- ▶ Turn the switch [1-11] to the **AC** symbol.

8.3 Special features of the CTM 36 E AC-LHS

To use the mobile dust extractor in combination with the **PLANEX**:

- ▶ Use kink-resistant suction hose D 36 mm x 3.5 m-AS.
- ▶ Use a special suction sleeve for connecting the **PLANEX**.
- ▶ Use closing slide CT-VS between the intake opening [1-2] and suction hose.
- ▶ Attach the tool holder.
- ▶ **Always use with a disposal bag!**

8.4 Extracting dry materials



CAUTION

Hazardous dust

Damage to the respiratory passage

- ▶ Use a filter or disposal bag when extracting hazardous materials!
- ▶ Do not use the machine if the volumetric flow monitoring function is inactive.

Observe the following when extracting dust generated by operating electric power tools: If the exhaust air is discharged back into the room, the **air renewal rate L** within the room must be sufficient. The volume of air discharged back into the room must not exceed 50% of the fresh air volume flow (room volume V_R x air renewal rate L_w). Observe all the relevant regional regulations.

Remember: A moist main filter clogs more quickly when extracting dry materials. Therefore, dry the main filter before extracting dust or replace the damp filter with a dry one.

8.5 Extracting wet materials/liquids



Remove the filter or disposal bag!

Recommendation: use special wet filter (NF-CT).

The dust extractor stops automatically when the maximum level is reached.

After wet extraction, allow the main filter to dry!



CAUTION

Escaping foam and fluids

- ▶ Switch off and empty the machine immediately.

8.6 After finishing work

- ▶ **Only versions with AutoClean:** Clean the main filter automatically or manually (see chapter 8.2).
- ▶ Switch off the mobile dust extractor and pull out the mains plug.
- ▶ Wind up the mains power cable.
- ▶ Empty the dirt trap.
- ▶ Close off the extractor opening [1-2] using the sealing plug [1-1].



WARNING

Hazardous dust

Damage to the respiratory passage

- ▶ Wipe down the mobile dust extractor and clean all accessories thoroughly using the extractor (inside and out) before removing from the working area.
- ▶ Parts that you were not able to clean thoroughly must be sealed in an airtight plastic bag prior to transportation.
- ▶ Wear a dust mask!



The machine shall be stored indoors only.

- ▶ Place the mobile dust extractor in a dry room inaccessible to unauthorised users.

9 Service and maintenance



WARNING

Risk of injury, electric shock

- ▶ Always disconnect the mains plug from the socket before performing maintenance work on the machine!
- ▶ All maintenance and repair work which requires the motor housing to be opened must only be carried out by an authorised service workshop.



Customer service and repair only through manufacturer or service workshops: Please find the nearest address at: www.festool.com/service



Only use original Festool spare parts! Order No. at: www.festool.com/service

Damaged safety devices and components must be repaired or replaced in a recognised specialist workshop, unless otherwise indicated in the operating manual.

Observe the following instructions:

- The manufacturer or an instructed person must perform a dust test at least once a year to determine whether the filter is damaged, the machine is sealed properly and the monitoring features are functioning correctly.
- Anything that cannot be cleaned must be discarded in impermeable bags. Observe applicable disposal regulations!
- For user servicing, the machine must be dismantled, cleaned and serviced, as far as is reasonably practicable, without causing risk to the maintenance staff and others. Suitable precautions include, decontamination before dismantling, provision from local filtered exhaust ventilation where the machine is dismantled, cleaning of the maintenance area and suitable personal protection.

9.1 Changing the filter element

NOTICE

Motor damage

- ▶ Never operate the extractor without a filter element fitted as the motor may become damaged.
- ▶ Open the locking clips **[2-2]** and remove the top section of the machine **[2-1]**.
- ▶ Turn the top section of the machine so that the main filter is facing upwards (Fig. **[9]**).
- ▶ Fold over the lever **[9-3]** and remove the retainer. **[9-2]**
- ▶ Remove the used main filter and replace **[9-1]** with a new one.
- ▶ Dispose of the used filter in accordance with statutory regulations.
- ▶ Insert the retainer **[9-2]** and fold over the lever **[9-3]** until it engages.
- ▶ Replace the top section **[2-1]** and close the locking clips **[2-2]**.

9.2 Emptying the dust container

The dust container **[2-3]** can be emptied once the top section has been removed.

- ▶ After extracting fluids, clean the fill level sensors **[10-1]** regularly with a soft cloth and inspect for damage.

10 Accessories

The order numbers for the accessories and filters can be found in the Festool catalogue or on the Internet at "www.festool.com".

11 Environment



Do not dispose of the device in the household waste!

Recycle devices, accessories and packaging. Observe applicable national regulations.

EU only: In accordance with the European Directive on waste electrical and electronic equipment and implementation in national law, used power tools must be collected separately and handed in for environmentally friendly recycling.

Information on REACH: www.festool.com/reach